

# OFFICE OF THE MUNICIPAL CORPORATION JAGDALPUR, DIST:-BASTAR

## Detail Estimate for Construction of RCC Drain Behind Sunder lal Sharma Atal Awas ward no-32 jagdalpur

Building SOR 01/01/2015

S.N	SOR ITEM	PARTICULAR ITEM	NOS	L	B	H/D	QTYS	UNIT	RATE	AMOUNT
1	1.1.	Excavation for all types and sizes of foundations, trenches and drains or for any other purpose including disposal of excavated stuff upto 1.5 m lift and lead upto 50m (at least 5m away from the excavated area), including dressing and leveling of pits.								
	1.1.1	In all types of soils.								
		Drain	1	200	2.1	1.9	798.00			
					Net qtys		798	cum	185.0	147630.00
	1.8	Extra rate for quantity of work executed in or under foul condition.								
		qtys as per exvation					798	cum	44.0	35112.00
2	1.10	Pumping out water caused by springs tidal or river seepage, broken water main or drains and like during Excavation or during Excavation and laying of base concrete (volume to be calculated taking height from water level to bottom of pit and to be measured and paid) .								
			1	200.00	2.1	0.9	378.0	cum	146.0	55188.00
3	1.18	Providing and filling in plinth with sand/ Crusher dust and hard moorum under floor in layers not exceeding 20cm in depth consolidating each deposited layer by ramming and watering, including dressing etc. complete.								
			1	200.00	2.1	0.1	42.00			
					Net qtys		42.00	cum	371.0	15582.00
4	3.1	Providing and laying nominal mix plain cement concrete with crushedstone aggregate using concrete mixer in all works upto plinth level excluding cost of form work.								
	3.1.2	1:3:6 (1 cement : 3coarse sand : 6 graded stone aggregate 40mm nominal size).								
			1	200.00	2.1	0.15	63.00			
					Net qtys		63.00	cum	2970.0	187110.00

3.10	Extra for laying PCC/ RCC, in or under water or liquid mud including cost of pumping or bailing out of water and removing slush etc. complete:					63.00	cum	261.0	16443.00
5	2.1	Providing and fixing form work including centring, shuttering, strutting, staging, propping bracing etc. complete and including its removal at all levels, for:							
	2.1.2	wall of any thickness including attached pilaster, buttresses etc.							
		wall							
		inner wall	2	200.0	1.5	600.0			
		outer wall	2	200.0	1.7	680.0			
		Rcc slab							
			1	25	1.9	47.5			
			2	25	0.1	5.0			
			2		1.9	0.1	0.38		
					Net qtys	1332.88	sqm	228.00	303896.64
6	3.2	Providing and laying nominal mix reinforced cement concrete with crushed stone aggregate using concrete mixer in all works upto plinth level excluding cost of form work.							
	3.2.1	1:1½:3 (1 cement : 1½ coarse sand : 3 graded stone aggregate 20mm nominal size).							
		flooring	1	200.0	1.9	0.2	76		
		wall	2	200.0	0.20	1.5	120		
		Rcc slab	1	50	1.90	0.1	9.5		
					Total	205.50	cum	4163.0	855496.5
7	1.26	Carriage by mechanical transport upto 5 km lead:							
	1.26.1	Earth							
		90% qty as per excavation and dismantal					718.20	cum	111.00
8	3.12	Providing and placing in position reinforcement for R.C.C. work including straightening, cutting, bending, binding etc. complete as per drawings including cost of binding wire in foundation and plinth all complete:							
	3.12.1	Thermo-Mechanically treated bars FE 415							
		75kg/cum					15412.50		
					Total	15412.50	kg	54.5	839981.25
									2536159.6
									25.36 lacs

  
Sub-Engineer  
Municipal Corporation  
JAGDALPUR (C.G.)

Assistant Engineer,  
Municipal Corporation  
JAGDALPUR (C.G.)

TS for Rs. 25,36,159.60  
BST No. 386  
Date 06/02/2026

  
Executive Engineer  
Municipal Corporation  
JAGDALPUR

# OFFICE OF THE NAGAR PALIK NIGAM JAGDALPUR

## Detail Drawing of the Construction of RCC Drain

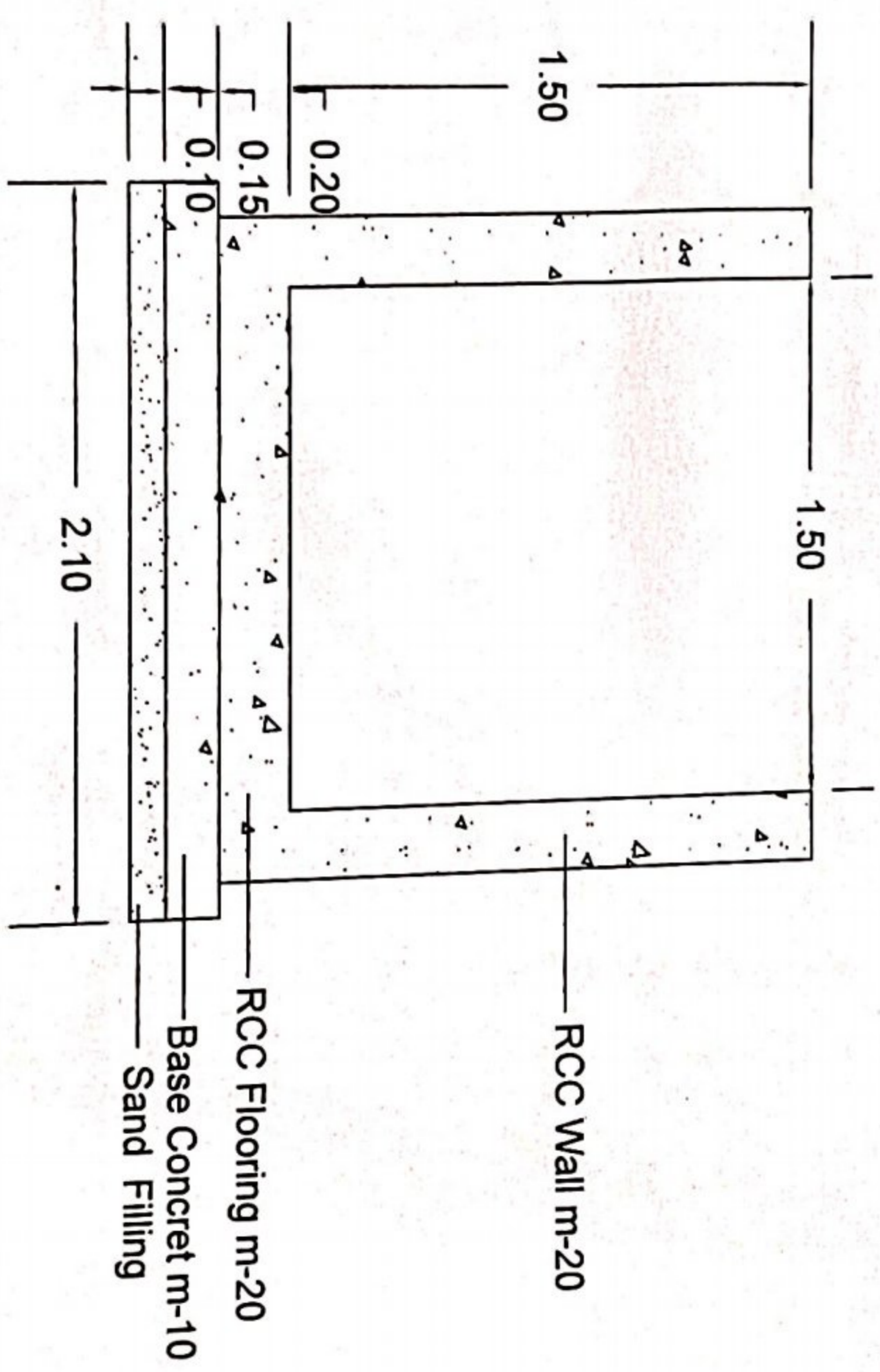

*[Signature]*  
Sub Engineer  
Municipal Corporation  
JAGDALPUR (C.G.)

Assistant Engineer  
Municipal Corporation  
JAGDALPUR (C.G.)

SHARMA WARD - (32)

AWAS AT

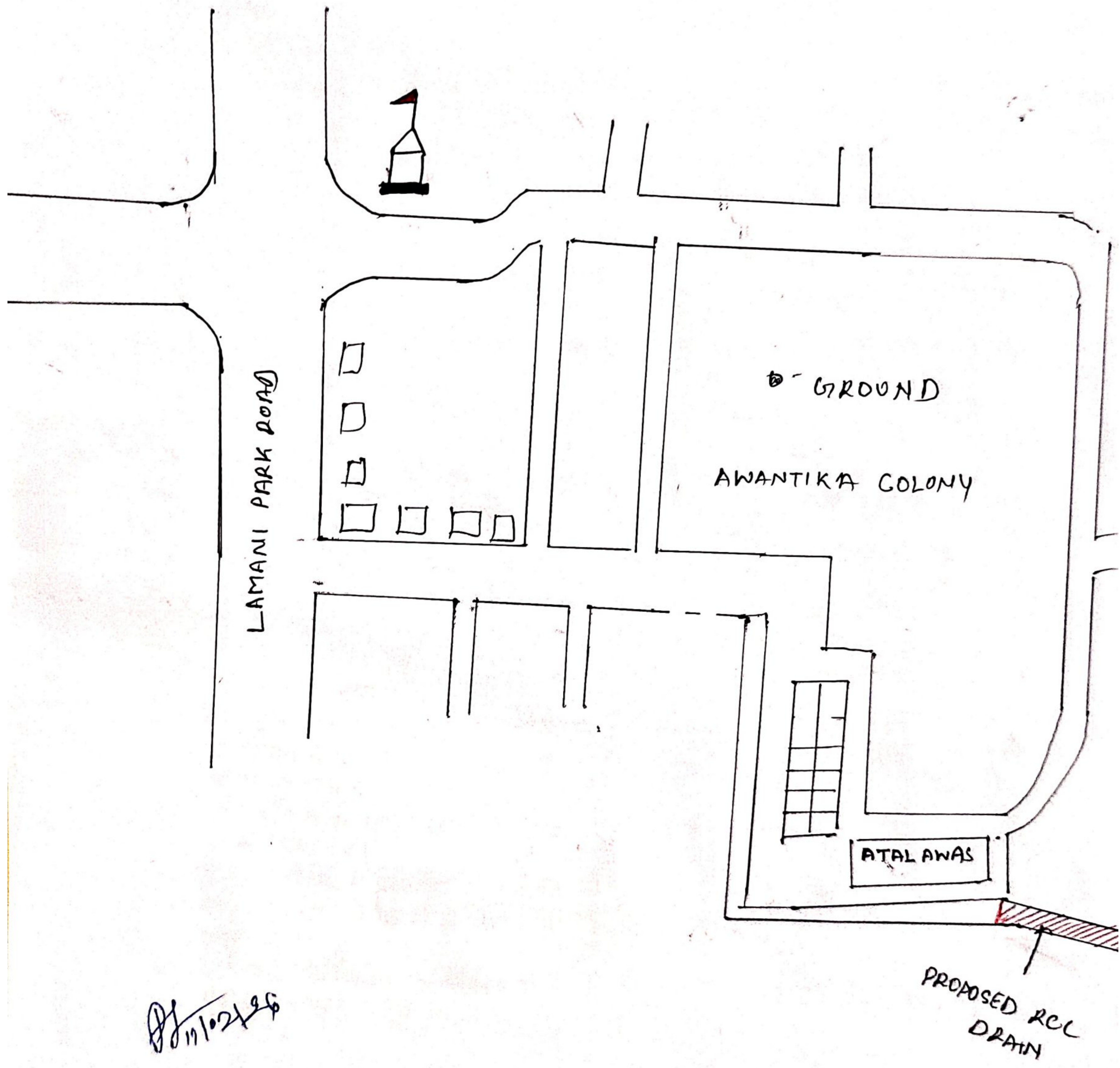

AS 11/02/26